

## Layout Parts

Model: PT3672

- (1) Table top
- (2) Leg assembly
- (1) Short brace
- (2) Long brace
- (2) Angle brace

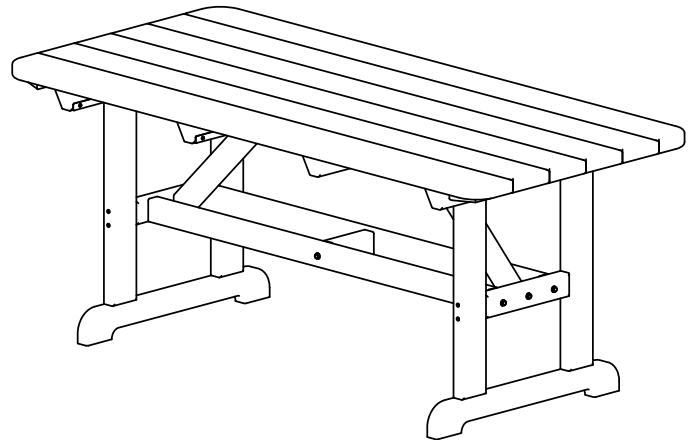

## Layout Hardware

QTY

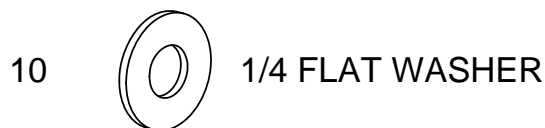
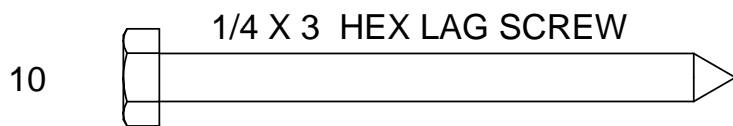
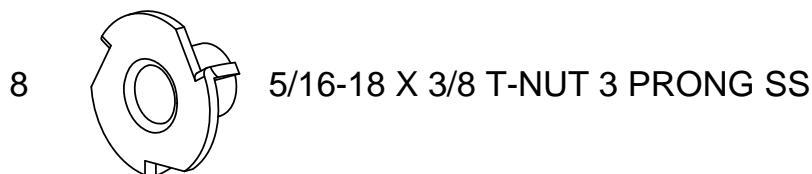
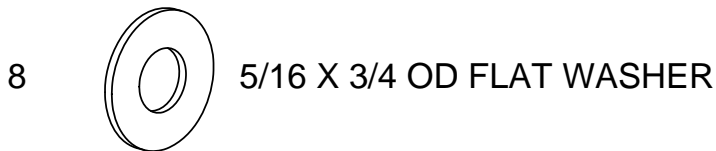
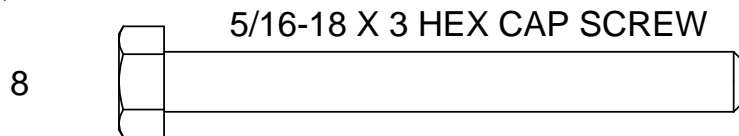

## Tools Needed

1/2" Socket drive  
7/16 Socket drive  
Hammer

## Assembly steps

**1**

Insert (8) T-nuts into all legs

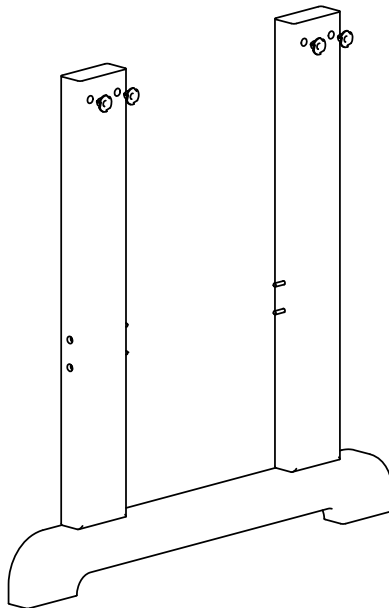

## Assembly Instructions Model: PT3672

**2**

- Place table top face down on clean, smooth surface
- Attach legs to top using (8) 5/16x3" Lags and Washers

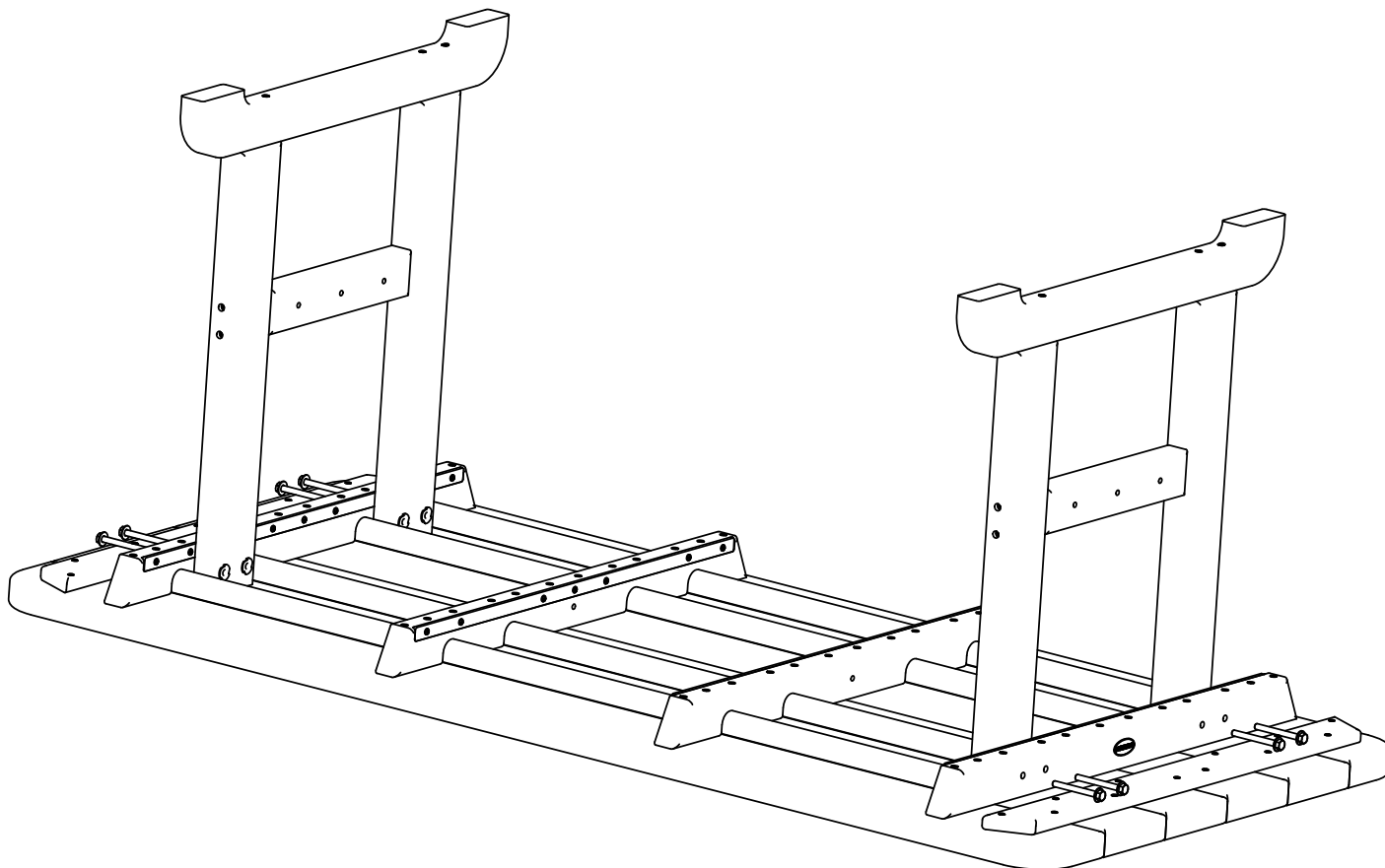

**3**

Attach long braces to legs using  
(4) 1/4x3" Lags and Washers

Attach short brace to long brace using  
(2) 1/4x3" Lags and Washers

## Assembly Instructions Model: PT3672

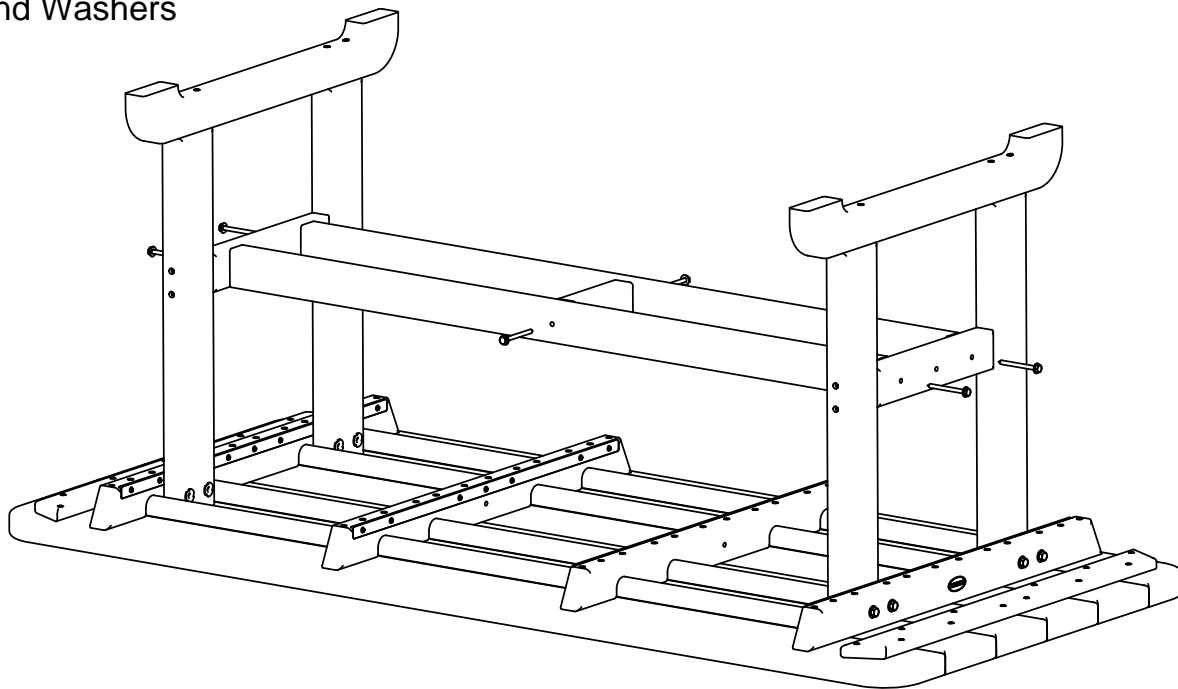
**4**

-Attach angle braces to legs using  
(2) 1/4x3" Lags and Washers

-Attach angle braces to top using  
(2) 1/4x3" Lags and Washers

